



baja designs
THE SCIENTISTS OF LIGHTING

2950 Norman Strasse Rd. San Marcos, CA 92069

squadron 2.0

INFO@BAJADESIGNS.COM
WWW.BAJADESIGNS.COM

PHONE 760-560-2252
FAX 760-560-0383

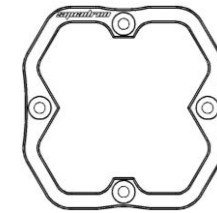

Digital Instructions

Mounting

Item	Description	Qty.
1	Squadron 2.0 Light	1
2	3/8 Bolt	2
3	3/8 Washer	2
4	M6 Nylock nut	2
5	M6 Button head Screw	2
6	Universal Bracket	1
7	3/8 Hex Bolt	1

Required tools: (1) 4 mm Hex Drive,
(2) 9/16" wrenches

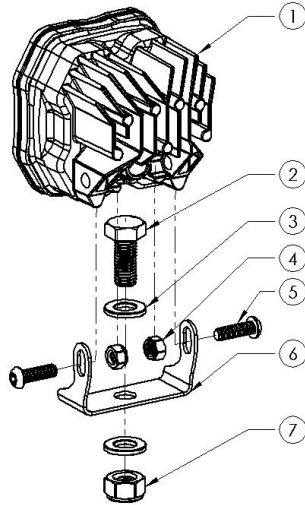

Mounting Instructions

1. Begin by removing light and bracket from box and orient as shown above.
2. Insert the 3/8" hex bolt and washers through the bracket hole as shown, then secure it with the 3/8" Nylock nut. Do not tighten yet.
3. Insert the M6 nuts into the molded pocket in the housing as shown below, with the Nylock portion facing the power cord.
4. Secure the bracket to the light using the M6 screws as shown. Leave them loose enough to allow in aiming the light.
5. Aim light and tighten all hardware.

Back of Squadron 2.0 Housing

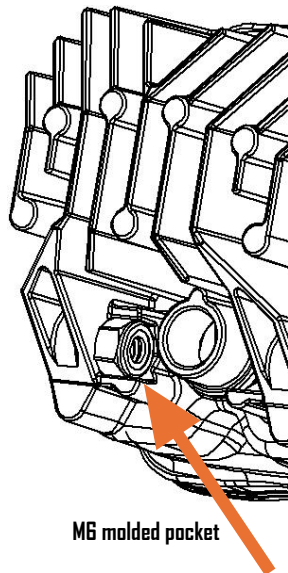

Angled Housing Mounting: Screw Position Guide

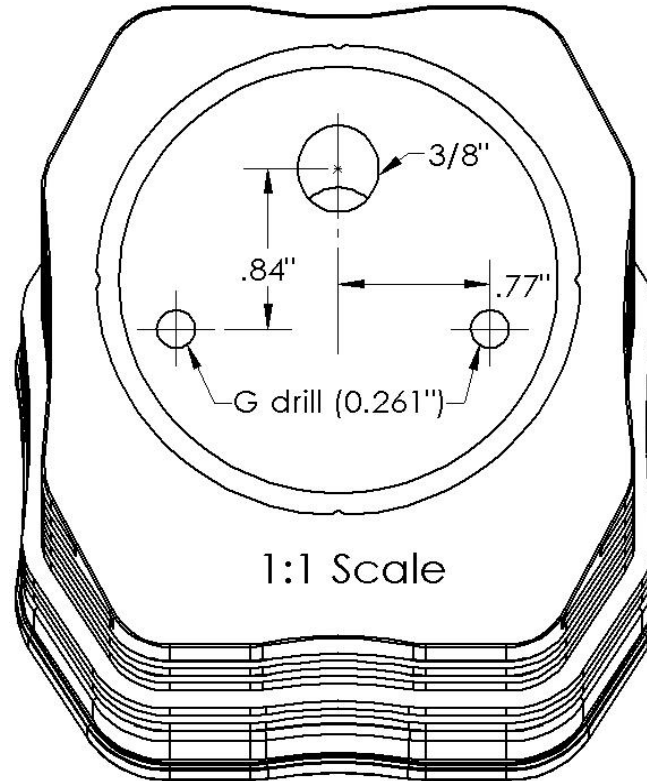

**** Make sure the printer scaling is set to Actual Size / 100% ****

- 1) Template above is only for Angled Housing Squadron product. Cut out template & hold on desired flat mounting surface. Use 3/8" drill for large hole & G drill (0.26") for two smaller holes. Deburr all edges.
- 2) Install the O-ring in the groove on the back of the light. *This helps prevent water from entering behind light but is not guaranteed. *
- 3) Feed the light's cord through the 3/8" hole & use the supplied connector to attach it to the light.
- 4) Use the provided M6X1.0 studs and associated hardware to fasten the light to the mounting surface. Use a thread locker when installing the hardware to ensure they remain securely fastened.

Light Orientation Limits and Positioning for Standard Bezel

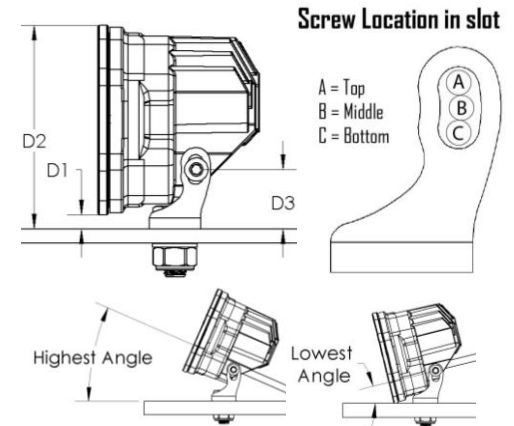

Configuration-Specific Min/Max Dimension Table

A (Top)	Lowest Angle		Highest Angle	
	-13.7		23.5	
D3	D1	D2	D1	D2
	1.17	0	3.25	4.16
A (Middle)	Lowest Angle		Highest Angle	
	-8.8		21.2	
D3	D1	D2	D1	D2
	1.04	0	3.3	4
A (Bottom)	Lowest Angle		Highest Angle	
	-4.12		18.67	
D3	D1	D2	D1	D2
	0.912	0	3.32	3.84

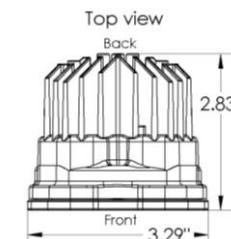

All angles are in degrees (°) and all distances (D) are in inches (in). Angles are measured from the horizontal. Positive angles are above the horizontal and negative angles are below the horizontal.



baja designs
THE SCIENTISTS OF LIGHTING

2950 Norman Strasse Rd. San Marcos, CA 92069

squadron 2.0

INFO@BAJADESIGNS.COM
WWW.BAJADESIGNS.COM

PHONE 760-560-2252
FAX 760-560-0383

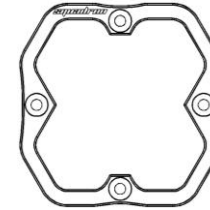

Digital Instructions

Light Orientation Limits and Positioning for Round Bezel

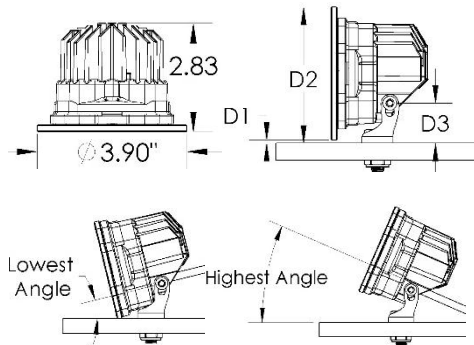

Configuration-Specific Min/Max Dimension

A (Top)		Lowest Angle		Highest Angle	
		-3.15		23.45	
D3	D1	D2	D1	D2	
1.17	0	0.03	0.802	4.427	
A (Middle)		Lowest Angle		Highest Angle	
		1.49		21.2	
D3	D1	D2	D1	D2	
1.04	0	3.9	0.599	4.28	
A (Bottom)		Lowest Angle		Highest Angle	
		6.08		18.62	
D3	D1	D2	D1	D2	
0.912	0	3.89	0.389	4.12	

All angles are in degrees (°) and all distances (D) are in inches (in). Angles are measured from the horizontal. Positive angles are above the horizontal and negative angles are below the horizontal.

Screw Location in slot

A = Top
B = Middle
C = Bottom

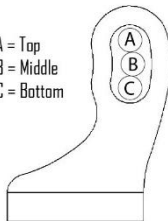

Connector Wiring

Front of male Deutsch connector

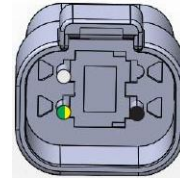

Squadron 2.0 Sport & Pro

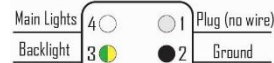

Pinning: Front of Connector

Back of male Deutsch connector

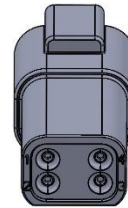

Squadron 2.0 Sport & Pro



Pinning: Back of Connector

Wire pinning

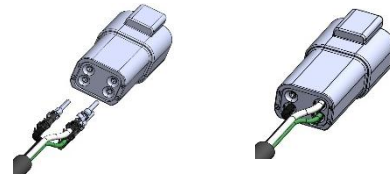

P/n of 4 pin male Deutsch: DT06-4S

Backlight Function

- Only operates on 12V nominal systems.
- Switch between 9 colors by momentarily applying power to the backlight, turning it off and turn it back on in under 3 seconds.
- Color is saved in memory when turned off.
- When the main lights are turned on, the Backlight is automatically switched off.
- If using triggered control, it is recommended to use an ignition source.

Flush Mounting: Positioning Guide

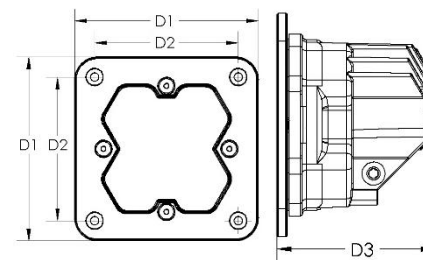
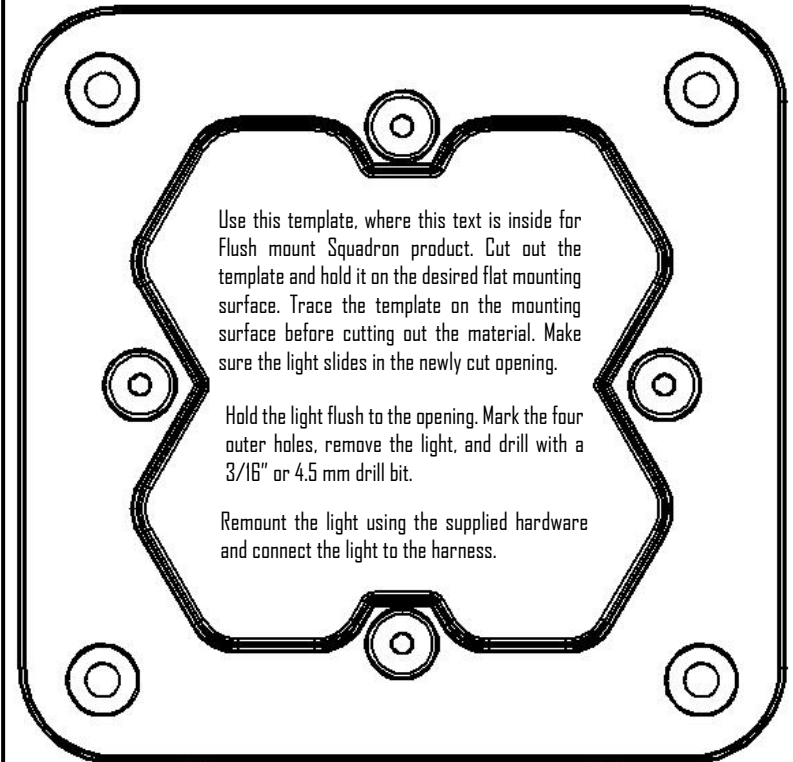

Dimensions

D1	4.000"
D2	3.125"
D3	2.838"

**** Make sure the printer scaling is set to Actual Size / 100% ****